



Jabra PanaCast

Engineered to be the world's first intelligent 180° Panoramic-4K plug-and-play video solution*

Inclusive meetings

Panoramic-4K video using three 13-megapixel cameras and patented real-time video stitching. 180° coverage gives a more natural, inclusive view of the huddle room; the perfect partner for rich Jabra Speak audio.

Intelligent video technology

Intuitive camera technology detects individual meeting participants and optimizes the field of view to include everyone in the conversation. Video quality is automatically and continuously optimized, even under varying lighting conditions, to provide a better viewing experience.

Instant collaboration

Plug-and-play technology lets you collaborate with others quickly and easily, bringing hassle-free video and audio to your huddle room.

Versatile compatibility

Compatible with all leading video- and audio-conferencing solutions. Certified for use with Microsoft Teams and works with Zoom, Cisco Webex and many more.



* See jabra.com/commercial-claims

How to set up

Camera positioning

Position the camera directly below the TV monitor, using the Jabra PanaCast wall mount*. For the most natural view of the huddle room, the camera should be mounted so that it is at eye level when seated.



How to connect

Instant collaboration – just plug in

Jabra PanaCast is compatible with all leading video and audio conferencing solutions, and is designed to work straight out of the box, with plug-and-play technology that lets you collaborate with others instantly.

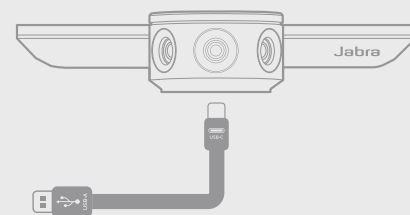

	Features	Benefit
Video	180° field of view	Natural view without distortion
	Panoramic-4K quality	Everyone looks sharp and in focus
Software	Intelligent Zoom	Automatically adjusts the field of view, so everyone is included in the conversation
	Vivid HDR	Optimizes video quality under varying lighting conditions
	Whiteboard**	Captures anything you write on a whiteboard in real-time, enhancing readability
Ease of use	Plug-and-play connectivity	Instant collaboration
	180° Video-flip	Allows you to flip the video feed if the device is installed upside down
Compatibility	Certified for use with Microsoft Teams and works with Zoom, Cisco Webex, and many more. For compatibility information go to jabra.com	



* Wall mount - optional accessory ** Available with future software update. Firmware upgrade required.